

# **LEDACRAFT MM-16 Oscillating Bobbin Sander**

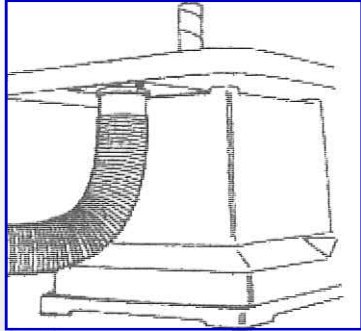

## **Built-in Dust Extractor Port**

Use 2" Hose or Adaptor (YW1031)  
to convert to 4" duct.

(see LEDA dust extractor fittings sheet)

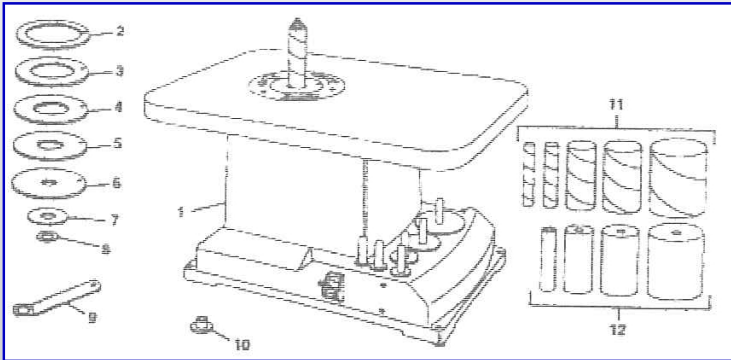

1. Oscillating Spindle Sander with 1" (25.4mm) Sanding Sleeve and 1" (25.4mm) Rubber Sanding Drum installed.
2. Throat Plate for 3" (76.2mm) Sanding Sleeve.
3. Throat Plate for 2" (50.8mm) Sanding Sleeve.
4. Throat Plate for 1½" (38.1mm) Sanding Sleeve.
5. Throat Plate for ¾" (19.1mm) Sanding Sleeve.
6. Throat Plate for ½" (12.7mm) Sanding Sleeve.
7. Spindle Washer for 3" (76.2mm) and 2" (50.8mm) Sanding Sleeve.
8. Spindle Washer for ½" (12.7mm) Sanding Sleeve.
9. 9/16" (14mm) Wrench.
10. Rubber Feet (4 pieces).
11. ½", ¾", 1½", 2" and 3" Sanding Sleeves.
12. ¾", 1½", 2" and 3" Rubber Sanding Drums.

- ◆ Single phase 0.25hp motor with on/off switch.
- ◆ Four pole motor to work at sanding speed of 1440rpm.
- ◆ Six bobbins included from 12.7mm to 75mm diameter.
- ◆ Bobbins oscillate up and down to spread work load on sandpaper.
- ◆ Bench model with white laminated board table.
- ◆ Six metal table inserts to suit all six bobbins.
- ◆ Six spindles moulded into machine body to store bobbins not being used.
- ◆ Dust extraction port below work table.

